

FOR SUBLEASE

2081 E. CHARTER WAY STOCKTON, CA

PROPERTY HIGHLIGHTS

- ±10,700 Total SF
- ±4,500 SF Warehouse
- ±6,200 SF Showroom/Office
- ±3.1 acre lot
- 4 ground level doors
- 16' to 18' clear height
- Fenced/paved yard
- Good access from Hwy 99 & Mariposa Street
- Visibility on Charter Way

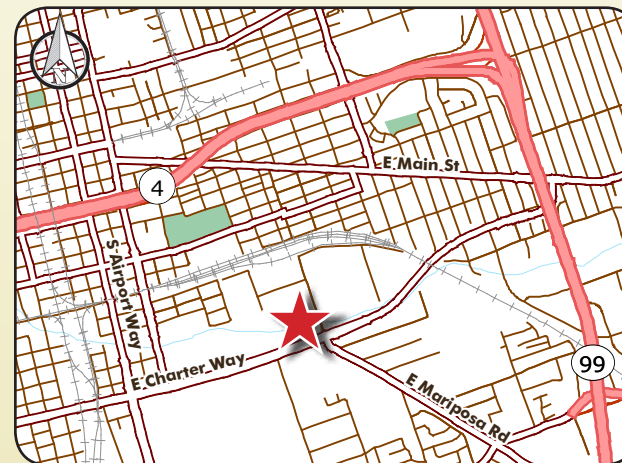

CENTRAL VALLEY COMMERCIAL

Grubb & Ellis Company
3031 W. March Lane, Suite 103
Stockton, CA 95219
209.473.3000 209.956.6839 fax
License #00812184

For more information, please contact:

Bryce MacDonald
209.473.3000

bryce.macdonald@grubb-ellis.com
License #01422174

Matt Cologna, SVP
209.956.4811

matt.cologna@grubb-ellis.com
License #01210309

Dave Hornbeck, LEED AP
916.418.6019

dave.hornbeck@grubb-ellis.com
License #01849016

The information contained herein was obtained from third parties, and it has not been independently verified by the real estate brokers. Buyers/tenants should have the experts of their choice inspect the property and verify all information. Real estate brokers are not qualified to act as or select experts with respect to legal, tax, environmental, building construction, soils-drainage or other such matters.

CENTRAL VALLEY COMMERCIAL



GRUBB & ELLIS
From Insight to Results

FOR SUBLEASE

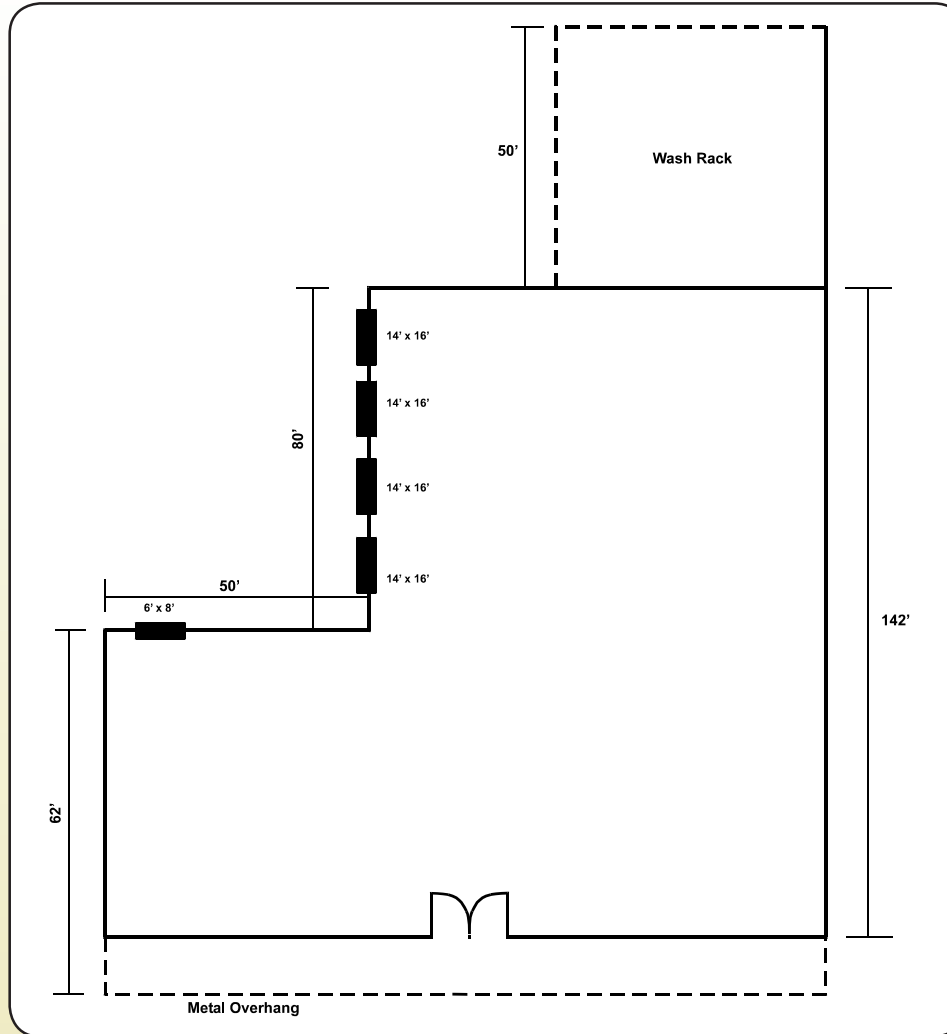

For more information, please contact:



Bryce MacDonald
209.473.3000
bryce.macdonald@grubb-ellis.com
License #01422174

Matt Cologna, SVP
209.956.4811
matt.cologna@grubb-ellis.com
License #01210309

Dave Hornbeck, LEED AP
916.418.6019
dave.hornbeck@grubb-ellis.com
License #01849016

